

EFX 800U/1000U/1200U/1500U



aquamantaTM
the experts in aquatic technology



Coldwater



Tropical



Marine



2+1
year
guarantee

**Instruction
Manual**

Technical Information

MODEL:	EFX 800U	EFX 1000U	EFX 1200U	EFX 1500U
DIMENSIONS:	38x26x33cm	54x32x35cm	63x37x38cm	63x37x38cm
MAX. AQUARIUM VOLUME:	250L	300L	350L	450L
MAX. HEAD HEIGHT:	1.5m	1.5m	1.7m	1.7m
FLOW RATE:	800L/hr	1000L/hr	1200L/hr	1500L/hr
WATTAGE:	27W	31W	55W	60W

Replacement Parts

Use only Aquamanta Genuine Spare Parts. See your local Aquamanta dealer and look for the number listed below for the spare part you require. Alternatively you will find these numbers on the silver label located on the product.

MODEL:	EFX 800U/1000U	EFX 1200U/1500U
IMPELLER:	001i	004i
WOOL PAD:	002w	005w
15ppi SPONGE PAD:	002s (1000U Only)	005s
35ppi SPONGE PAD:	001s	004s
PHOSPHATE SPONGE:	007s	008s
ACTIVATED CARBON:	001c	004c

NOTE: Different wool pads and 35ppi sponges are made to suit the top basket with a different hole size to those in the lower baskets. Refer to image in page 4.

- Before operating the appliance, please read this manual carefully and keep it properly for future reference.
- Follow the instructions and the “important safeguards” in this manual before use.
- Please be aware of the guarantee conditions which are found at the end of this section of the instruction booklet. This product is shipped to you in a factory sealed carton. Should the product malfunction in any way or if the unit is damaged and requires replacement, contact the retailer where the product was purchased for inspection.
- Do not discard packing material until the product has been assembled.

Important Safeguards

To guard against injury, basic safety precautions should be observed, including the following:

1. Read and follow all safety instructions and important notices in these instructions as well as on the product itself.
2. This appliance is not intended for use by children or infirm persons without supervision. Young children should be supervised to ensure that they do not play with the appliance.
3. To avoid possible electric shocks, special care should be taken since water is employed in the use of aquarium equipment. For each of the following situations do not attempt repairs yourself. Return the appliance to an authorised service facility for service or discard the appliance.
 - a. If the appliance or any electrical component of the appliance (non-immersible equipment only) falls into the water or gets wet, do not reach for it. Unplug it and then retrieve it.
 - b. If the appliance shows any sign of abnormal water leakage, immediately unplug it from the power source.
 - c. Carefully examine the appliance after installation. It should not be plugged in if there is water on parts which are not intended to be wet.
 - d. Do not operate the appliance if it has a damaged cord or plug, or if it is malfunctioning, or dropped or damaged in any manner.
4. A “drip loop” (see graphic) should be arranged for each cable connecting an aquarium to a power supply. The drip loop is the part of the cable below the level of the power supply. It prevents water travelling down the cable and coming into contact with the power supply. If the plug or the socket does get wet, do not unplug the appliance. Disconnect the fuse or circuit breaker that supplies the power to the appliance, then unplug and examine for presence of water in the socket.
5. Always unplug the appliance from the electrical outlet when not in use, before putting on or taking off parts, before any type of maintenance or cleaning.
6. Never yank the cable to pull it from the socket. Pull the plug carefully to disconnect.
7. Do not use the appliance for reasons other than the intended use. The use of attachments that are not recommended or sold by the manufacturer may cause the product to be unsafe. This is not recommended.
8. Do not install or store the appliance where it will be exposed to weather or temperatures below freezing.
9. Make sure any component mounted on a tank is securely installed before operating it.
10. Ensure input voltage is the same voltage as your local power supply.
11. If an extension cable is used it should have the proper rating. Care should be taken to arrange the cord so that it will not be tripped or pulled.
12. A G.F.C.I (Ground fault circuit interrupter) & surge protector is recommended for all electrical appliances.
13. Ensure your hands are dry when turning the power switch on/off and when inserting/removing the power cable from the socket.
14. If you are in any doubt about the electrical installation or safety of this product you must consult a qualified electrician.

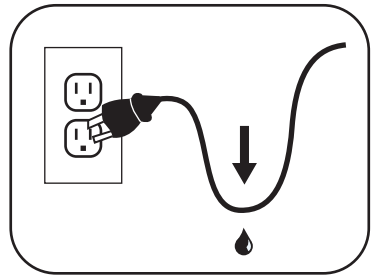

Overview

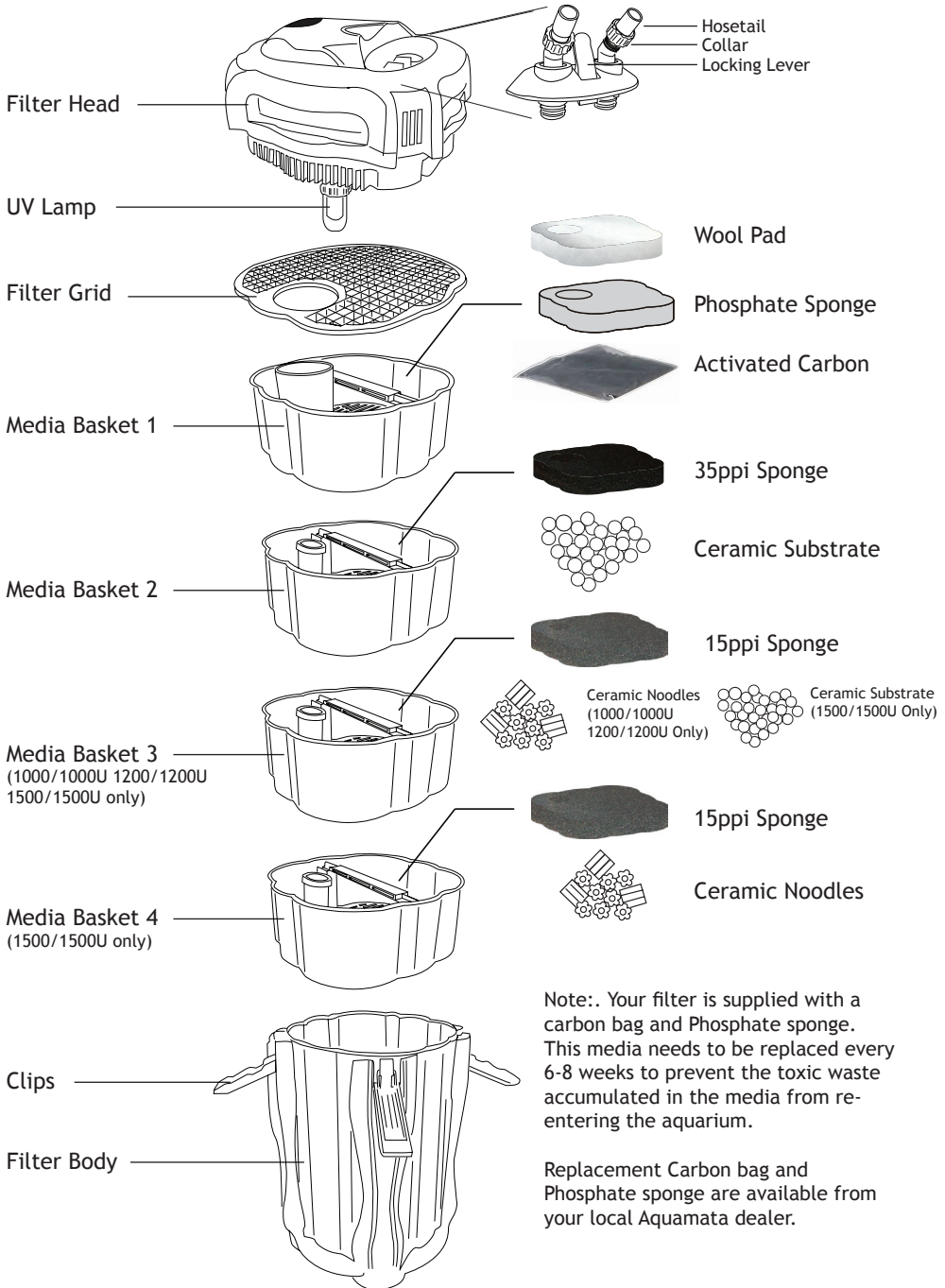

Note:.. Your filter is supplied with a carbon bag and Phosphate sponge. This media needs to be replaced every 6-8 weeks to prevent the toxic waste accumulated in the media from re-entering the aquarium.

Replacement Carbon bag and Phosphate sponge are available from your local Aquamata dealer.

Overview

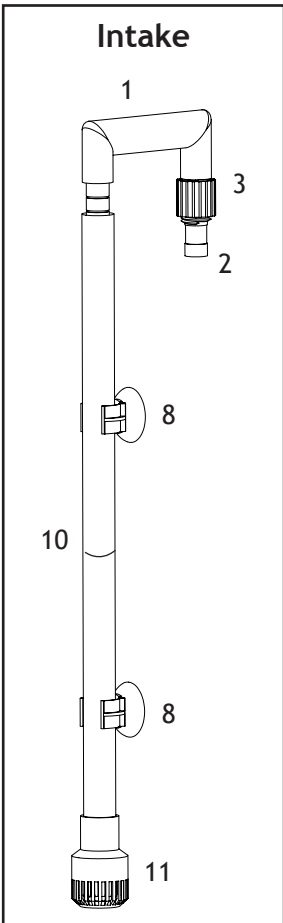
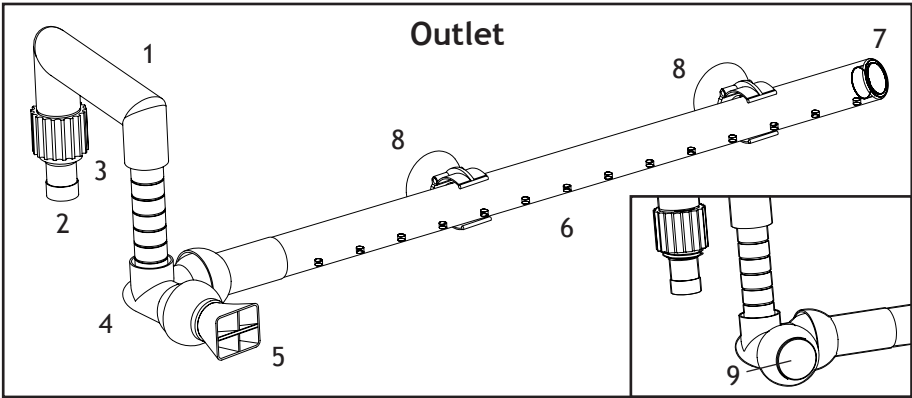

- 1. U-pipe
- 2. Hosetail
- 3. Collar
- 4. Elbow
- 5. Duckbill outlet
- 6. Spray bar
- 7. Endcap
- 8. Suction cup
- 9. Outlet cap
- 10. Adjustable Intake pipe
- 11. Strainer

Setup Instructions

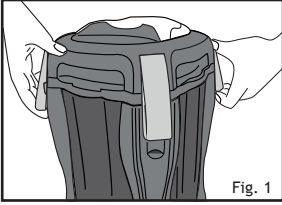

1. Open the filter unit. To do this, release the 4 clips located on the corners of the filter. Fig. 1

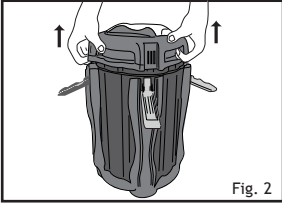

2. Lift the head unit off the canister body. Place it somewhere safe where it will not be stepped on or broken. Fig. 2

3. Take the canister body to the sink. Ensure the area is clean and free of detergents.

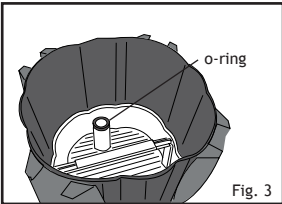

4. Remove the filter grid and the filter media baskets from the canister. (Refer to overview)

5. Follow the filter media layout in the overview which apply to your filter. Remember to remove all media from the plastic bags and rinse in tap water to remove excess dust. The simplest way to do this is to empty the correct media into its basket and run tap water through it. Rinse the inside of the canister body in tap water. **DO NOT USE ANY SOAPS OR DETERGENTS.**

6. Once all the filter media and the canister body have been washed and the sponges have been inserted into the media baskets, place the media baskets in the correct order back into the canister body (refer to overview). Ensure the baskets are all correctly aligned and the black o-rings are in place on the media baskets, excluding the top basket. Fig 3

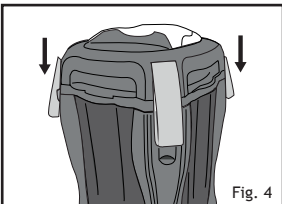

7. Prior to installing the head unit, turn it over so you can see the impeller. Ensure the power cord is not wet and plug into the power outlet then turn it on. Ensure the unit is working, this includes both the priming pump and the impeller.

8. Align the filter inlet with the pipes in the media baskets and press the head unit down gently. If the head does not seal properly, check the alignment of the media baskets and ensure they are sitting correctly.

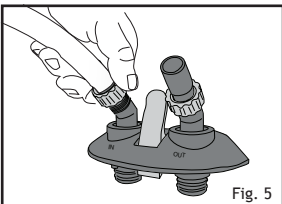

9. Latch and secure the clips. The filter unit is now ready to be installed. Fig 4

Installation

10. Open the accessory box and remove all components from the plastic bags. You will find a set of taps and 2 lengths of hose. Screw the collars of the taps all the way down (clockwise).

11. Push one end of the hose down onto the hometail and screw the collar up (anticlockwise) over the hose. Repeat for second hometail. Do not overtighten, hand tight is sufficient. Fig 5

12. Attach the taps to the top of the filter head and push the locking lever down to lock the taps into position.

Setup Instructions

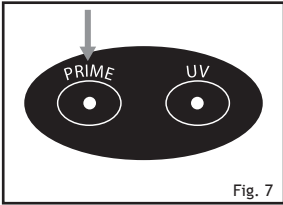
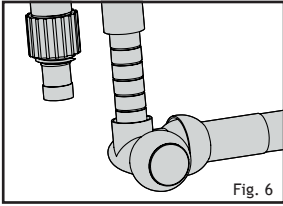

13. Place the filter in the desired location and feed the hoses to the top of the aquarium.

14. Assemble the intake as shown in the overview. The Intake can be adjusted up and down to suit the depth of the aquarium.

15. Choose which outlet option you want to use. The elbow has 2 outlets which can be connected to 2 spray bars, 2 duckbill outlets, one of each or one of the outlets can be covered with a cap (Fig. 6) to give a single outlet option. The spray bar can be extended using the connector supplied. To provide sufficient pressure for the extended spray bar it is highly recommended that the second outlet be capped.

NOTE: If you are unsure about which outlet option is best for your application, seek advice from your local Aquamanta dealer.

16. Place the intake and outlet at opposite ends of the aquarium, this will ensure there is water movement through the full length of the aquarium. Suctions cups should be used to hold the intake and outlet pipes in place.

17. Connect each hose to the hoesetail on one of the u-pipes. The Intake u-pipe has 2 o-rings on the tank side (1200/1500 only) whereas the outlet has none. The tap is marked "IN" and "OUT" to indicate the Intake and outlet hose. The hose should be cut to length ensuring there is sufficient slack on the hoses so that they can be moved and the u-pipes can easily be removed from the aquarium without having to disconnect the hose.

18. Ensure all connections are firmly in place and the taps are open, the locking lever should be pressed down.

19. Ensure the power cable and plug are dry and connect to the power outlet. Switch the outlet on.

20. Press the "prime" button on the top of the filter head to start the filter. The priming pump will run for approximately 40 seconds. During this time, water should begin to flow through the filter and you will see water flow from the outlet. If the filter is not fully primed when the priming pump switches off it can be run for another 40 seconds by pressing the "prime" button again. Fig. 7

NOTE: The aquarium must be filled with water for the filter to prime.

21. To switch the UV lamp on, press the button marked "UV" next to the priming button. Fig 7.

Maintenance

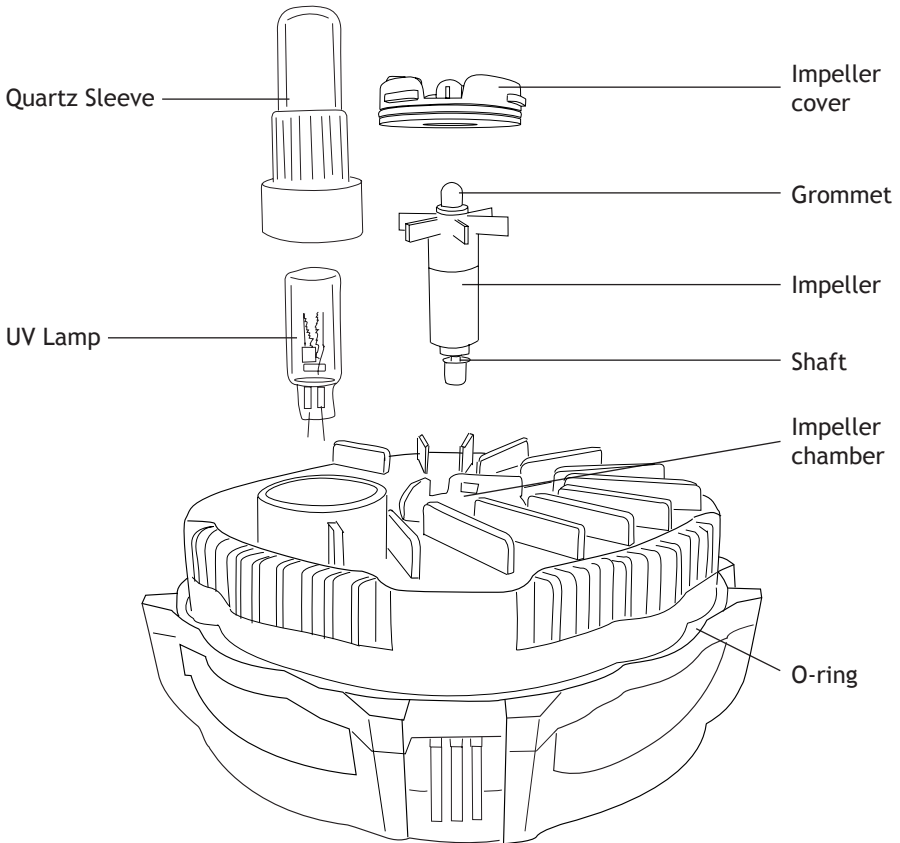

1. Turn the filter off at the power outlet and unplug the unit.
2. Place a towel under the filter unit. This will prevent any water spilling onto your cabinet or stand and damaging it.
3. Lift the locking lever to turn the taps off. Remove the tap from the filter head.
4. Fill a bucket with water from your aquarium and take it to wherever you intend to clean the filter. Keep in mind cleaning the filter can be messy and it is recommended that you clean the filter outside or at a sink. Ensure the area is free of soaps and detergents.
5. Open the canister. Follow steps 1-4 on page 6.
6. Remove the media baskets from the filter body using the handles on the baskets.
7. Remove the sponges and wool from the media baskets and rinse the remaining media in the bucket of water. To do this simply immerse the basket in the water and shake lightly to remove any debris that has accumulated on the media.

Maintenance

NOTE: Biological media (including sponges) should never be rinsed in tap water as the chlorine will kill the beneficial bacteria.

8. Rinse the sponges in the bucket. These will eventually need replacing, if the sponges seem to be falling apart or they do not appear clean after maintenance, they should be replaced.

9. Replace the wool pad. Wool pads should be replaced regularly as they collect the fine waste and they deteriorate quickly.

10. The Carbon bag and Phosphate sponge needs to be replaced every 6-8 weeks. Replacement Carbon bag and Phosphate sponge are available from your local Aquamata dealer.

11. Place all media back in their respective baskets and place the media baskets back into the filter body.

12. The impeller should be checked and cleaned whenever the head is removed from the filter.

13. Turn the filter head over and turn the impeller cover clockwise to remove it. Remove the impeller from the impeller chamber.

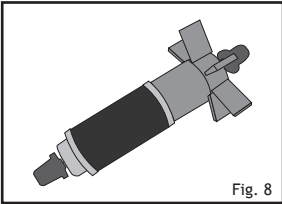

14. Using a double ended brush, clean the impeller chamber. At the same time, clean the outlet tube with the double ended brush.

15. Remove the grommets and shaft from the impeller and run water from the tap through the centre of the impeller. Clean the impeller as well as the shaft and grommets.

16. Put the impeller, shaft and grommets back together and ensure the impeller moves freely on the shaft. Place the impeller back into the impeller chamber and replace the impeller cover.

17. Place the filter head back onto the filter ensuring all the media baskets have been correctly aligned.

NOTE: It is recommended that an aquarium safe lubricant be applied to the o-ring on the filter head each time it is removed for maintenance. This prolongs the life of the o-ring and also makes it easier to remove the filter head next time the filter has to be disassembled.

18. Reconnect the taps and ensure all connections are correctly in place.

19. Check the inlet and outlet pipes and attachments and clean if necessary.

20. Plug the filter unit in at the power outlet and switch the power on. Make sure the priming pump is operating and there is no water leaking out of any plumbing connections.

UV Lamp Replacement

The filter will indicate when the UV lamp needs replacing when the LED on the UV button is flashing. To replace the UV Lamp, simply unscrew the collar at the base of the quartz sleeve and gently pull the lamp from the socket. Replace the lamp and reattach the quartz sleeve. Ensure the collar is secured firmly.

Troubleshooting

FILTER UNIT IS LEAKING

1. Check all o-rings are in place and they are not damaged.
2. Apply aquarium safe lubricant to o-rings where leaking is occurring.
3. Check the media baskets are aligned correctly.
4. Check that the intake pipe on the filter head is aligned correctly with the media baskets.

FILTER WILL NOT PRIME

1. Check hoses for kinks.
2. Ensure the taps are fully open, the locking lever should be pushed down.
3. Ensure the aquarium is full, the filter may not prime if the water level is too low.
4. Ensure the hoses are connected correctly, the intake pipe should be connected to the "IN" connection on the taps and the outlet should be connected to "OUT".
5. Ensure the intake pipe and/or strainer are not blocked.

FILTER WILL NOT START

1. Refer to previous tips.
2. Check that the impeller and shaft are in good condition. When the filter head has been removed, turn the power on to check if the impeller is running.
3. Check that the power outlet is switched on and the filter is plugged in.

LOW WATER FLOW

1. As above.
2. Clean the filter media. Replace wool/sponges if necessary.
3. Check the intake and outlet pipes and fittings are clean and not blocked.

BOTH WATER AND AIR ARE COMING FROM THE OUTLET PIPE

1. Check whether priming pump is running, if so, wait a few minutes.
2. Ensure there are no airstones running near the intake pipe/strainer.
3. Check all pipes are firmly connected.
4. Check o-rings and apply aquarium safe lubricant if necessary.
5. Gently rock the filter back and forth to discharge any air in the filter.

FILTER IS MAKING NOISE

1. Refer to previous tips.
2. Check that the intake and outlet pipes are not blocked.

Disposal of used Electrical & Electronic Equipment (Applicable in the European Union and other European countries with separate collection systems)



This symbol on the product or on its packaging indicates that the product must not be disposed of with normal household waste. Instead, it is your responsibility to dispose of your waste equipment by arranging to return it to a designated collection point for the recycling of waste electrical and electronic equipment. By separating and recycling your waste equipment at the time of disposal you will help to conserve natural resources and ensure that the equipment is recycled in a manner that protects human health and the environment. For more information about recycling this product, please contact your local city office, your household waste disposal service or the shop where you have purchased the product.

Guarantee

The additional 1 Year **Extended Guarantee** applies when you REGISTER online with Aquamanta. Register your Extended Guarantee at www.aquamanta.com.au

About this Guarantee

The Manufacturer or Distributor, of Aquamanta goods, is collectively known herein as “Aquamanta”. Please refer to contact details for Aquamanta below or on the applicable Aquamanta website. Any product that is covered by its own Guarantee (as enclosed with the product) is subject to the conditions of that Guarantee.

Australian Guarantee

Important note: This guarantee applies in addition to the guarantees, rights and remedies conferred by the Australian Consumer Law and other applicable Commonwealth, State and Territory legislation. The guarantee does not exclude, affect or limit those guarantees, rights or remedies, except to the extent that their application may lawfully be excluded or limited.

In particular, our goods come with guarantees that cannot be excluded under the Australian Consumer Law. You are entitled to a replacement or refund for a major failure and for compensation for any other reasonably foreseeable loss or damage. You are also entitled to have the goods repaired or replaced if the goods fail to be of acceptable quality and the failure does not amount to a major failure.

International Guarantee

The benefits given to the purchaser, under Guarantee, are in addition to all other statutory rights and remedies which the purchaser has in respect of goods under legislation in the applicable country of purchase. This Guarantee shall not affect any such rights and should be read subject to such legislation.

1.0. Terms and Conditions of Guarantee.

- 1.1. Aquamanta warrants to the purchaser, for 2 Years from date of original purchase, to repair or replace goods where fault is found due to defective materials or faulty workmanship and where goods do not operate in accordance with the instructions.
- 1.2. All claims for repair or replacement must be made at place of purchase.
- 1.3. The original and dated Proof of Purchase (receipt) must be supplied with all goods claims. Please also provide this Guarantee where possible.
- 1.4. The Guarantee covers the Aquarium against gluing breakdown resulting in leakage.
- 1.5. All goods subject to claim under Guarantee should be prepared for transportation in the original packaging or other comparable packaging which offers the same degree of protection.
- 1.6. Where goods are repaired or replaced under Guarantee, these goods are Guaranteed for the remainder of either the original Guarantee or Extended Guarantee period.
- 1.7. Where claims on inspection reveal goods are in normal working order, Aquamanta will request reimbursement of all reasonable costs incurred.

2.0. Other Terms and Conditions - Extended Guarantee

- 2.1. The Extended Guarantee period is for an additional 1 Year and commences on expiration of the standard guarantee period.
- 2.2. Application for Extended Guarantee is FREE of any registration cost to the purchaser on completion of the Extended Guarantee questionnaire which is found on the applicable Aquamanta website (refer below).
- 2.3. Upon receipt and acceptance of the questionnaire, Aquamanta will forward (by way of email) a Certificate of Extended Guarantee to the purchaser.
- 2.4. For more information on how we collect, hold, use and disclose personal information provided to us, please refer to our Privacy Statement on the Aquamanta websites or write to our Privacy Officer, in your country of purchase.
- 2.5. Where Aquamanta determines goods are being used in a manner contrary to the instructions, specifications or this Guarantee, Aquamanta reserves the right to terminate Extended Guarantee for such goods and will provide written notice to the purchaser.

3.0. Exclusions and Limitations

Where permitted by local law, the following exclusions and limitations apply in regard to Guarantee:

- 3.1. Goods claims where fault is due to, but not limited by a) misuse b) neglect c) abuse d) fire or flood e) normal wear and tear f) accidental breakage g) Acts of God h) mains voltage fluctuation or supply problems i) connection to any voltage other than what is stated on the rating plate j) modification or tampering to electrical cord or plug, k) vermin, insects or foreign object l) liquid spillage or submersion of goods not designed to sustain such use or duress.
- 3.2. Where inspections reveal goods are in normal working order including where noise or vibration is consistent with normal goods operation.
- 3.3. Attempted repairs or modifications by unauthorised persons, including but not limited to the drilling of holes in the aquarium glass by unauthorised persons.
- 3.4. Where the goods factory rating plate has been removed, altered, damaged or is rendered illegible.
- 3.5. Where goods are not installed, operated or maintained in accordance with Aquamanta's goods instructions, specifications or this Guarantee.
- 3.6. Replacement or repair of worn consumables or replacement of lost goods, parts or components.
- 3.7. Costs associated with goods transportation, removal, installation, postage or cost of insurance.
- 3.8. Any damage incurred whilst installing, transporting or moving the goods.
- 3.9. Subject to certain local statutory rights and obligations to the contrary, and this guarantee shall not affect those rights or obligations, where, to the full extent permitted by law: 1. all express and implied warranties and conditions under statute or general law, are expressly excluded and Aquamanta, where permitted, will limit liability as follows and at Aquamanta's option to: in regard to goods either a) the replacement of goods or supply of equivalent goods b) the repair of goods or the cost of replacing the goods or of acquiring equivalent goods OR in regard to services either c) the re-supply of services d) the cost to re-supply services.
2. Aquamanta will not be liable for any loss or damage, including consequential loss or damage either directly or indirectly, or for any incidental expenses, of any kind, and in any way whatsoever.

(1) Consumables include items such as filter media/cartridges, impellers shafts and lamps.

The additional 1 Year Extended Guarantee applies when you REGISTER online with Aquamanta. Register your Extended Guarantee at www.aquamanta.com.au

Local distributors of Aquamanta products can be found at www.aquamanta.com.au



aquamantaTM
the experts in aquatic technology

Manufactured in China
Aquamanta and Kong's are registered
trademarks of Kong's (Aust.) Pty Limited.
www.aquamanta.com.au



Instruction version: 13/03/2013

